

**1745C**

**Rear Mount**



**17" CRT Touchmonitor**

**SPECIFICATIONS**

<b>Model</b>		1745C
<b>Case/Bezel color</b>		Metal/black
<b>Display type</b>		FST CRT
<b>Display size</b>	Diagonal	17.0" (43.2 cm)
	Viewable	15.8" (40.1 cm)
<b>Display area dimensions, nominal</b>	Default	12.0" (30.5 cm) H x 9.0" (22.9 cm) V
	Maximum	12.2" (31.1 cm) H x 9.1" (23.0 cm) V
<b>Monitor dimensions</b>	Width	16.5" (42.0 cm)
	Height (including base)	13.2" (33.8 cm)
	Depth (including base)	16.3" (41.5 cm)
<b>Dimensional drawing number</b>		MS500144 (available at <a href="http://www.elotouch.com">www.elotouch.com</a> )
<b>Highest recommended resolution</b>		1024 x 768 at 85 Hz
<b>Resolution presets</b>		1280 x 1024 at 65 Hz (PC)
		1024 x 768 at 85 Hz (PC)
		1024 x 768 at 75 Hz (Mac)
<b>Dot pitch, nominal</b>		0.27 mm
<b>Video bandwidth</b>		110 MHz
<b>Scanning frequency</b>		Horizontal 30–70 kHz; vertical 50–150 Hz
<b>Input video format</b>		Analog (no proprietary video card needed)
<b>Input video signal connector</b>		Mini D-Sub 15-Pin (female)
<b>Power supply</b>		90–264 VAC, 50–60 Hz
<b>Power dissipation</b>		80 W max.
<b>Temperature</b>		Operating 10°C to 40°C; storage –20°C to 60°C
<b>Humidity</b>		Operating 35% to 80%; storage 5% to 85%; noncondensing
<b>Weight (approx.)</b>		Actual 39.0 lb (18.0 kg); shipping 47.0 lb (21.0 kg)
<b>Warranty</b>	Monitor	2 years
	Touch technology	5 years iTouch touchscreen
	Touch controller	5 years
<b>Other features</b>		Digital on-screen display (OSD); ENERGY STAR; VESA DPMS/Nutek; VESA DDC 1/2 B Plug and Play; ISO 9241/3

**ORDERING INFORMATION**

<b>Touch Technology</b>	<b>Touch Interface</b>	<b>Surface Treatment</b>	<b>Elo Part Number</b>	<b>Agency Approvals</b>
iTouch	Serial	Antiglare	140926-000	UL, cUL, FCC, CE, TUV-GS, MPR II
iTouch	USB	Antiglare	453624-000	UL, cUL, FCC, CE, TUV-GS, MPR II

- Users should independently evaluate the suitability of the product for their application.
- All prices, models, and availability subject to change without notice.

- Stock quantities may be limited. Larger quantities are available within one week.
- For Product Agency Certifications refer to our Web site.

17" CRT Touchmonitor

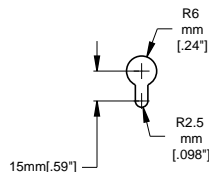
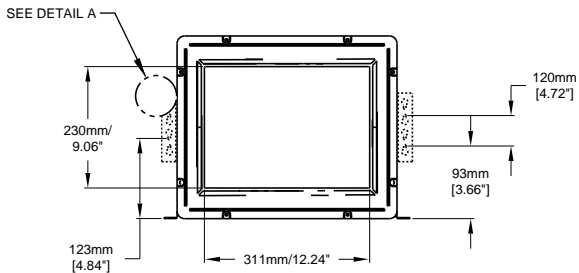
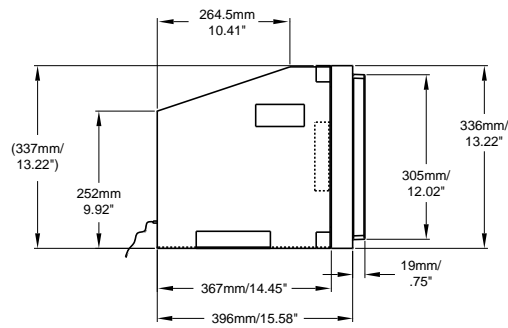
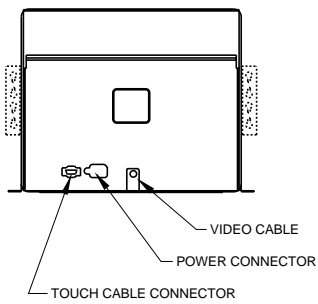
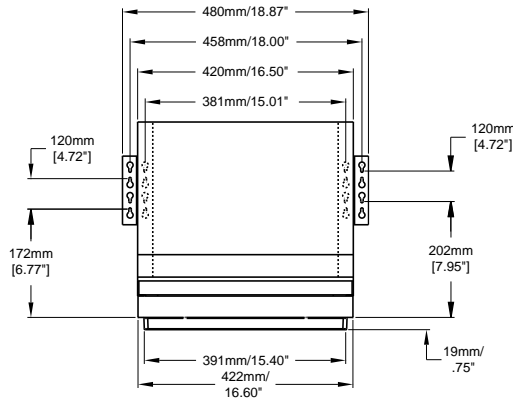
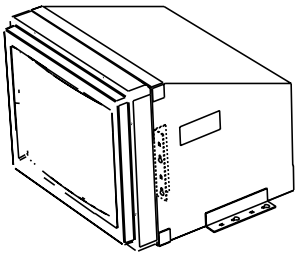

DETAIL A  
SCALE 5:1

NOTE:  
OSD CONTROLS ACCESSED  
FROM BOTTOM OF UNIT